

## Specifications

# SMART Mobile Height-Adjustable Floor Stand

## Model FS-UX

### Physical Specifications

#### Size

Without SMART Board™ Interactive Whiteboard	44" W × 74" H × 40" D (112 cm × 188 cm × 102 cm)
Maximum Display Size With SMART Board SB685ix Interactive Whiteboard (not included)	77 1/2" W × 99" H × 40" D (197 cm × 251 cm × 102 cm)
Minimum Mobility Size With SMART Board SB685ix Interactive Whiteboard (not included)	77 1/2" W × 74" H × 40" D (197 cm × 188 cm × 102 cm)
Maximum Display Size With SMART Board SB685i3 Interactive Whiteboard (not included)	77 1/2" W × 99" H × 72 1/4" D (197 cm × 251 cm × 184 cm)

#### Weight

Without SMART Board Interactive Whiteboard	236 lb. (107 kg)
With SMART Board SB685ix Interactive Whiteboard (not included)	300 lb. (136 kg)
With SMART Board SB685i3 Interactive Whiteboard (not included)	312 lb. (142 kg)

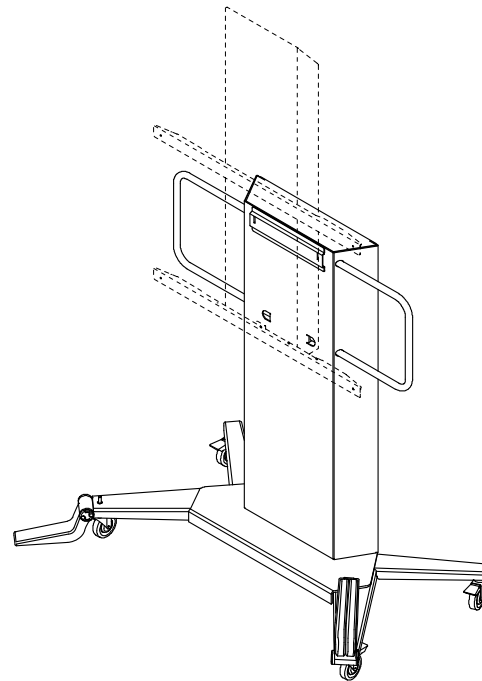

All dimensions +/- 1/8" (0.3 cm). All weights +/- 2 lb. (0.9 kg).

## Standard Features

<b>Adjustable Height</b>	25" (63 cm) of vertical travel allows you to raise or lower the interactive whiteboard to a convenient height within that range.		
With SMART Board SB660 Interactive Whiteboard	<ul style="list-style-type: none"> <li>Reach points for the floorstand with this interactive whiteboard:</li> </ul>		
	<b>Interactive Whiteboard Position</b>	<b>Lowest Reach point</b>	<b>Highest Reach Point</b>
	Lowest position	9" (22 cm)	57 1/2" (146 cm)
	Highest position	34" (86 cm)	82 3/8" (209 cm)
With SMART Board SB680 or SB685 Interactive Whiteboard	<ul style="list-style-type: none"> <li>Reach points for the floorstand mounted with these interactive whiteboards:</li> </ul>		
	<b>Interactive Whiteboard Position</b>	<b>Lowest Reach Point</b>	<b>Highest Reach Point</b>
	Lowest position	11 1/4" (28 cm)	57 1/2" (146 cm)
	Highest position	36 1/4" (92 cm)	82 3/8" (209 cm)
	The motor has a lift capacity of 125 lb. (56.7 kg).		
<b>Power Source</b>	<p>You can set the voltage switch to either 120V AC or 240V AC.</p> <p>Product uses 100 W while raising or lowering your interactive whiteboard and 1 W in standby mode.</p>		
<b>Security</b>	The height-adjustable mount locks in position when you turn off the power.		
<b>Mobility</b>	<p>Equipped with four swivel-locking casters</p> <p>Equipped with anti-tip feet compliant with CSA/CE safety requirements</p>		
<b>Room-to-Room Mobility (SMART UX60 Only)</b>	Can pivot through a 29 1/2" (75 cm) doorway in a standard wall		
	 <b>IMPORTANT</b> <ul style="list-style-type: none"> <li>The floorstand with the SMART UX60 projector system is designed to pivot to pass through a doorway. Passages or other obstructions leading to or from the doorway can hinder pivoting, and the floor stand might not pass through.</li> <li>The floorstand with the SMART UF55 projector system is designed for in-room mobility only. Because of the length of the projector boom, it will not pass through standard doorways.</li> </ul>		
<b>Environmental Compliance</b>	EU WEEE, EU RoHS, US CPSIA, packaging laws and China's Electronic Information Products regulations		
<b>Regulatory Certification</b>	CSA, CE, C-Tick and FCC		
<b>Warranty</b>	Two-year limited equipment warranty		

## Storage and Operating Specifications

Operating Temperature	Operating temperature range depends on your projector and interactive whiteboard. Please refer to the product documentation for more information.
Storage Temperature	-40°F to 140°F (-40°C to 60°C)
Humidity	95°F (35°C) with up to 85% relative humidity, non-condensing

## SMART Order Numbers

FS-UX	Height-adjustable, mobile cart solution for SMART Board interactive whiteboards. This product includes both a height-adjustable frame and the cart. When combined with an interactive whiteboard system, this product provides room-to-room mobility (SMART UX60 systems) and in-room mobility (SMART UF55 systems)
FS-UX-LTS	Optional laptop shelf, featuring a fixed tilt angle
<b>SMART UX60 Projector System</b>	This system provides some room-to-room mobility.
SB685ix	SMART Board 685ix interactive whiteboard system (includes a SMART Board 685 interactive whiteboard, integrated with a SMART UX60 ultra-short-throw projector)
SBD685ix	SMART Board D685ix interactive whiteboard system (includes a dual-touch SMART Board 685 interactive whiteboard, integrated with a SMART UX60 ultra-short-throw projector)
SBA-L	Optional speakers for the SB685ix system
<b>SMART UF55 Projector Systems</b>	The following systems provide in-room mobility only.
SB660i3	SMART Board 660i3 interactive whiteboard system (includes a SMART Board 660 interactive whiteboard, integrated with a SMART UF55 projector)
SB680i3	SMART Board 680i3 interactive whiteboard system (includes a SMART Board 680 interactive whiteboard, integrated with a SMART UF55 projector)
SB685i3	SMART Board 685i3 interactive whiteboard system (includes a SMART Board 685 interactive whiteboard, integrated with a SMART UF55 projector)
SBD680i3	SMART Board D680i3 interactive whiteboard system (includes a dual-touch SMART Board 680 interactive whiteboard, integrated with a SMART UF55 projector)
SBD685i3	SMART Board D685i3 interactive whiteboard system (includes a dual-touch SMART Board 685 interactive whiteboard, integrated with a SMART UF55 projector)
SBA	Optional speakers for SMART UF55 projector systems

## Physical Dimensions, Maximum Display Dimensions

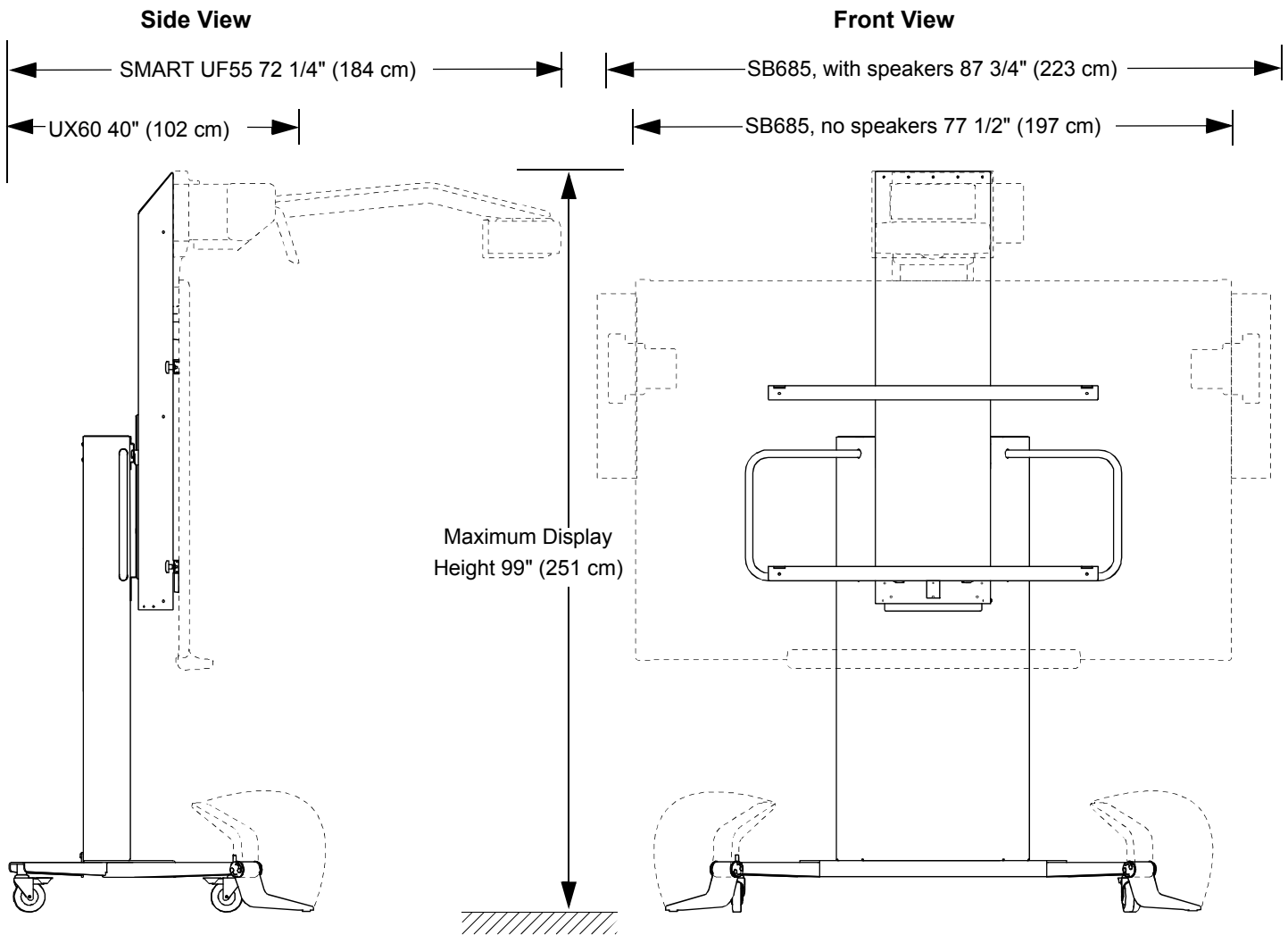

## Physical Dimensions, Mobility

**Side View**

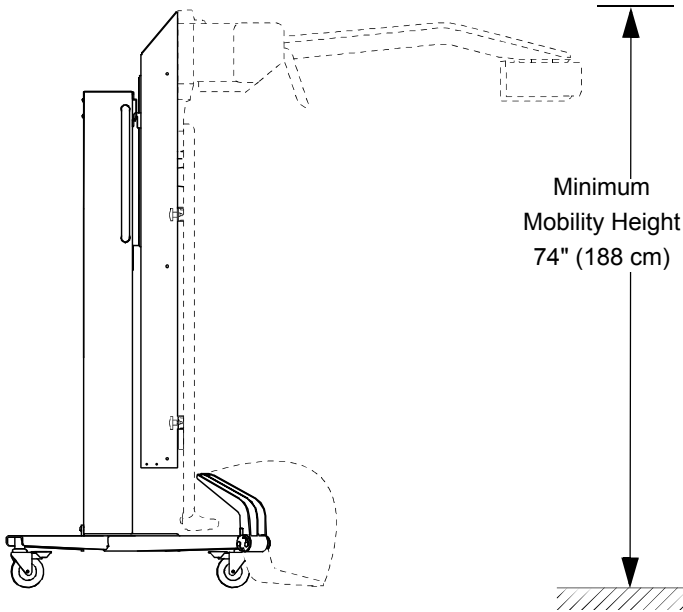
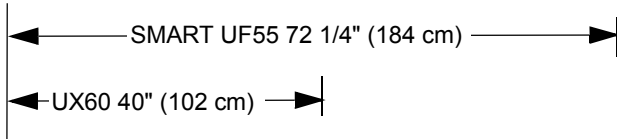

**Front View**

